

# Steel Reducing Bushings

- Reduce trade size of tapered entry on a conduit fitting
- Threaded for Rigid Conduit & IMC
- Rolled edge protects wire insulation

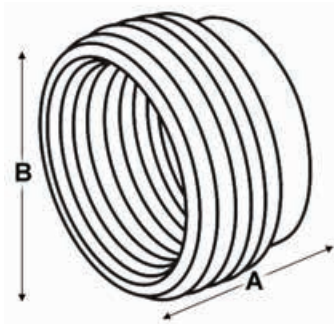

DIMENSIONS = INCHES

CAT. NO.	TRADE SIZE	DIMENSIONS		INNER BOX	OUTER BOX
		A	B		
14660	1/2" X 3/8"	.63	.91	100	1,000
14661	3/4" X 1/2"	.65	.93	100	1,000
14662	1" X 1/2"	.72	1.13	50	500
14663	1" X 3/4"	.72	1.13	50	500
14664	1-1/4" X 1/2"	.82	1.47	10	100
14665	1-1/4" X 3/4"	.82	1.47	25	250
14666	1-1/4" X 1"	.81	1.47	25	250
14667	1-1/2" X 1/2"	.85	1.70	10	100
14668	1-1/2" X 3/4"	.85	1.70	25	100
14669	1-1/2" X 1"	.85	1.70	25	100
14670	1-1/2" X 1-1/4"	.85	1.70	10	250
14671	2" X 1/2"	.97	2.23	10	40
14672	2" X 3/4"	.97	2.23	10	40
14673	2" X 1"	.97	2.23	10	40
14674	2" X 1-1/4"	.97	2.23	10	100
14675	2" X 1-1/2"	.97	2.23	10	100
14676	3" X 1/2"	1.57	3.43	-	10
14677	3" X 3/4"	1.57	3.43	-	10
14678	3" X 1"	1.57	3.43	-	10
14679	3" X 1-1/4"	1.57	3.43	-	10
14680	3" X 1-1/2"	1.57	3.43	-	10
14681	3" X 2"	1.57	3.43	-	10
14682	3" X 2-1/2"	1.57	3.43	-	10
14683	4" X 1/2"	1.68	4.43	-	5
14684	4" X 3/4"	1.68	4.43	-	5
14685	4" X 1"	1.68	4.43	-	5
14686	4" X 1-1/4"	1.68	4.43	-	5
14687	4" X 1-1/2"	1.68	4.43	-	5
14688	4" X 2"	1.68	4.43	-	5
14689	4" X 3"	1.68	4.43	-	5

# Polypropylene Stud Bushings

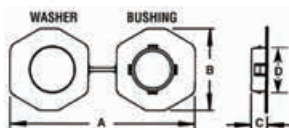

- Fits existing irregular shaped holes in metal studs  
Alleviates the need to punch holes in metal studs, weakening the structural member
- Protects wire insulation from abrasion in metal studs
- Bushing allows smooth wire pulling
- No tools needed
- Use these bushings to comply with paragraph 300-4(b)(1) of the 2005 NEC code which states that: "In both exposed & concealed locations where nonmetallic-sheathed cables pass through either factory or field punched, cut, or drilled slots or holes in metal members, the cable shall be protected by bushings or grommets covering all metal edges & securely fastened in the opening prior to installation of the cable"

DIMENSIONS = INCHES

CAT. NO.	STUD SIZE	DIMENSIONS				BAG QTY
		A	B	C	D	
21760	2X4	5.67"	2.50"	.505"	1.30"	25

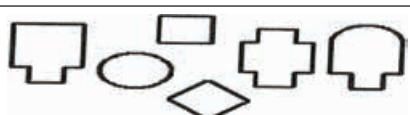

Examples of common hole configurations in metal studs that stud bushing protects